



Goodall Gallery at Columbia College welcomes solo, duo, group, and curated exhibition proposals, open to all artistic disciplines, media, and concepts. Located in the Spears Center for the Arts, the gallery presents high-quality exhibitions featuring local, regional, national, and international artists to educate, enrich, and engage the students, the campus, and the public. We are interested in innovative approaches that address contemporary issues and/or contribute to the diverse cultural landscape through a personal language and voice. Proposals are being considered for Fall 2026-Fall 2028.

ELIGIBILITY

Open to all professional artists 18 years or older. Applicants may not be full or part-time students at the time of submission.

All media welcome, including but not limited to painting, sculpture, photography, mixed media, ceramics, fiber, video, performance, installation, digital, and new media work.

SUBMISSION GUIDELINES

1. **Please read General FAQs (below) before applying.** This includes instructions, images of the gallery, and a floor plan.
2. If you are applying as a duo, collective, curator, or group show, the application should be submitted by a single lead applicant.
3. All artwork must be original artwork created within the last 5 years.
4. **Fill out the [application form](#)**
5. Send a single .pdf **no larger than 5MB** with 10-20 images, clearly labeled with: Artwork Title, Media, Dimensions, Year to goodallgallery@columbiasc.edu by **11:59 PM on 01.20.26.**
6. **If you are including time-based work**, please include installation/performance shots or video stills where applicable. You may include a link in place of or to coincide with images. **Please note that the exhibition committee is only asked to watch/listen to the first minute of time-based media.**
7. Email's subject line should read: **Last Name_First Name_Images**

8. We do not accept folders, single images, or multiple files. If an applicant's image file is not the correct file type (.pdf), exceeds the size requirement, is corrupted, or cannot be opened, the application will not be considered.

GENERAL FAQS:

Gallery Mission: To educate, enrich, and engage the students, the campus, and the public by presenting quality art exhibitions that support the mission of Columbia College and promote the visual arts in the community through the accessibility of artworks and artists who have established a personal language and voice to express issues of personal significance.

Selection Process: Our goal is to assemble a dynamic year-round exhibition season that engages the students and the greater art community. All submissions are reviewed and scored by the exhibition committee on professional and accurate documentation, strong conceptual and academic rigor, relevance to contemporary issues, originality, and technical skills. Proposals should include a clear presentation format and be feasible within our gallery spaces.

The committee also considers the artist's ability to articulate their ideas, overall professional experience, and potential for student and community engagement. Submissions from both local and visiting artists are welcome.

Key Dates:

Submission Deadline: 01.20.26

Notification of Acceptance Round 1: Mid-February, 2026

Notification of Acceptance Round 2: Mid-March, 2026

Applying for Main Gallery: The Main Space at Goodall Gallery showcases professional emerging and established artists working across a wide range of media, with particular interest in practices rooted in academic inquiry and contemporary discourse. While an M.F.A. is not required, it is considered a positive indicator of an applicant's commitment to their field.

We seek proposals that bring thought-provoking concepts, strong technical skills, and clear articulation of ideas to our campus community. Selected exhibitions should challenge expectations, introduce work less commonly seen in this region, and contribute meaningfully to the cultural dialogue at Columbia College. Applicants should also demonstrate a willingness to engage with students and the broader art community through conversation, visibility, or programming connected to their work.

LOFT Gallery:

The LOFT Gallery is designed to showcase professional artists while offering a particularly strong opportunity for emerging practitioners or those working with a smaller, more focused body of work. Due to the spatial limitations of this passageway-style gallery, the LOFT is best suited for 2D artwork, low-relief 3D pieces, mixed-media wall works, and select wall-based or suspended installations. It is not an ideal venue for large sculptural objects or floor-based installations.

Beginning in Fall 2025, we have approached the LOFT as a complementary curatorial space to the Main Gallery. Exhibitions in the LOFT are thoughtfully paired with the visiting or featured artist in the Main Space, considering how the two bodies of work can enter into dialogue when presented in proximity.

Local artists interested in being considered for future LOFT exhibitions may elect to have their name added to a two-year curated list of regional artists that we draw from when forming these pairings. To be included, please indicate your interest in the application form.

Equipment Support:

2, 55" monitors (Smart TVs), 5 media players, cord covers, 4 HDMI cords, 2 smaller monitors (one flat, one older), 2 projectors (artist is responsible for blacking out space or creating an enclosure).

Access to 3 ladders, standard tools, & hardware.

Gallery Hours:

M-F, 10 AM-5 PM, except for academic holidays and special events.

Opening/Closing Receptions with Artist Talk:

Held on Thursday or Friday from 5-7 PM

Layout: See Diagram and images below.

For Questions, Please email Brittany M. Watkins at: bwatkins@columbiasc.edu

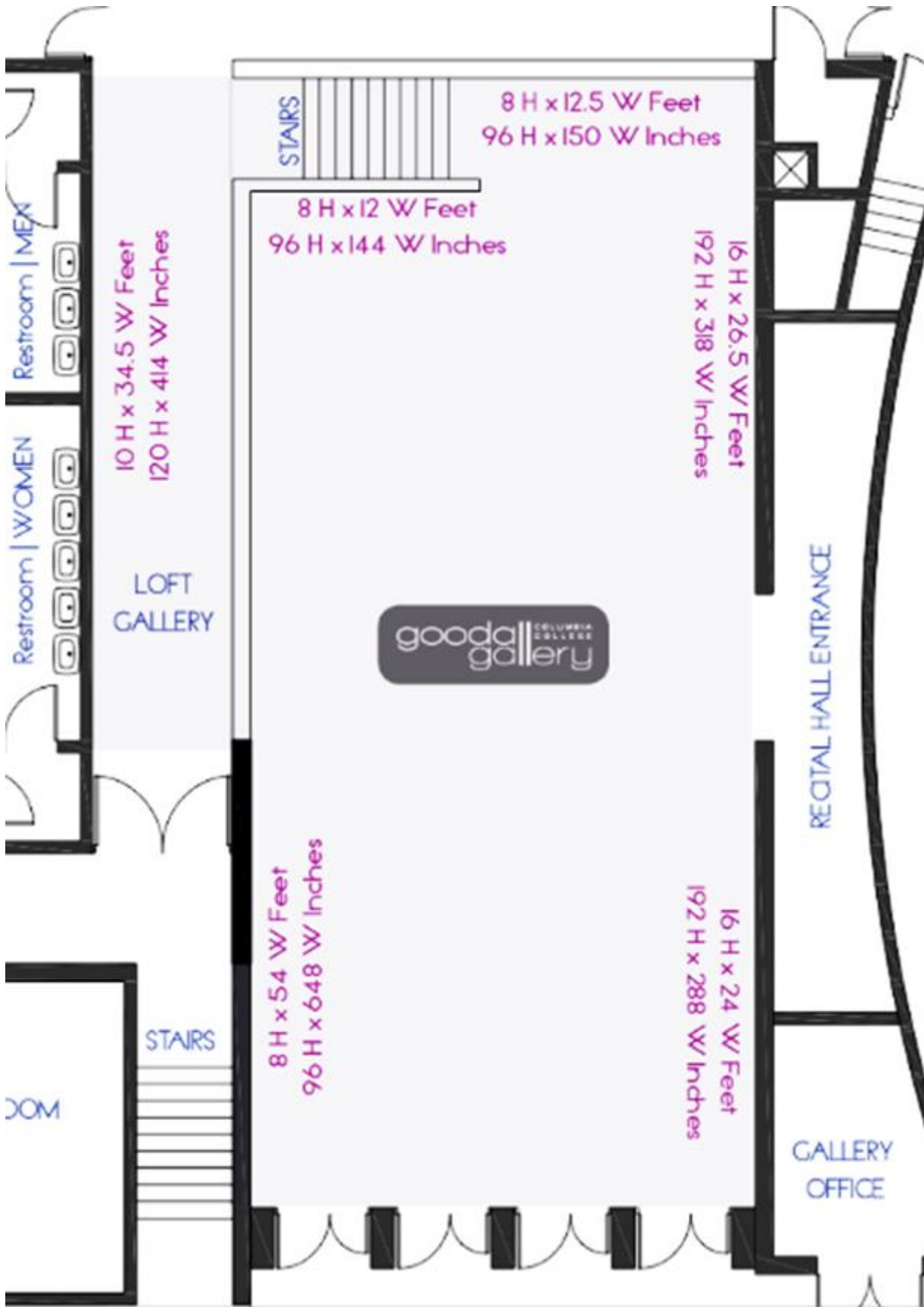

IMAGES OF THE GALLERY







IMAGES OF THE LOFT

